



Your **ONE STOP** Dump Body Manufacturer

WIRING DIAGRAM



Type: **INNVX0161-G LANAU DUMP BODY**
Fits on: **ALL LANAU DUMP BODIES MODELS.**
Product: **HI / TEMP. VOLT FLEX SXL WIRE HARNESS AND LED LIGHTS KIT.**

- = 2 contacts pigtail
 - = sealed 3 contacts pigtail
 - = Crimp and shrink butt splice
- Use low punch die on your tool for best installation.

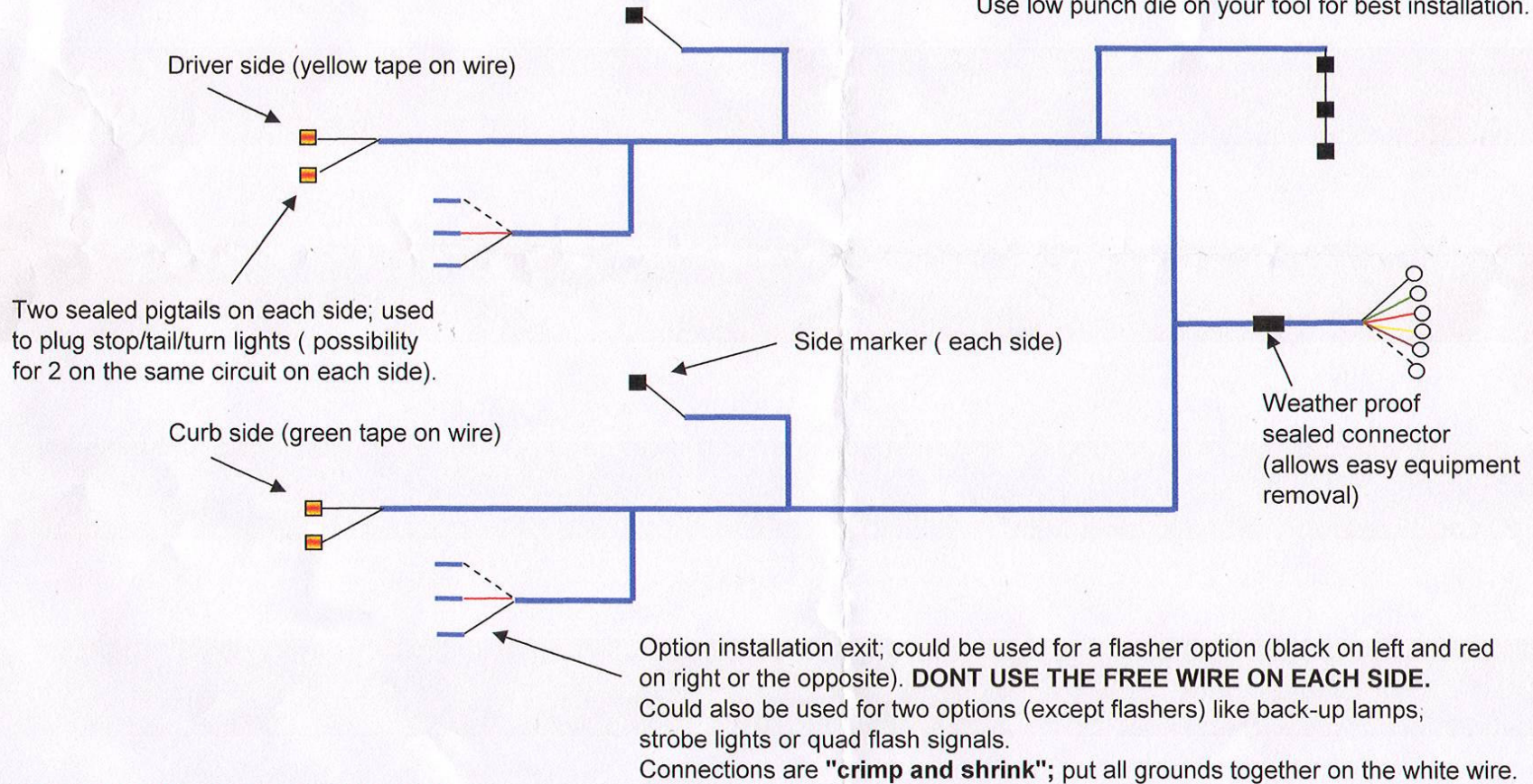

Copyright; Voltflex Innovations Inc. 2008.